

### 6.3 MASSING COMPARISON

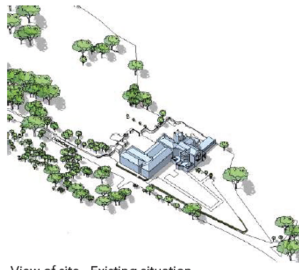

View of site - Existing situation

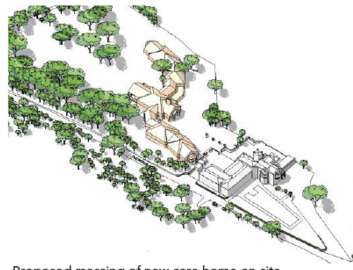

Proposed massing of new care home on site



Massing of proposed demolition of existing care home

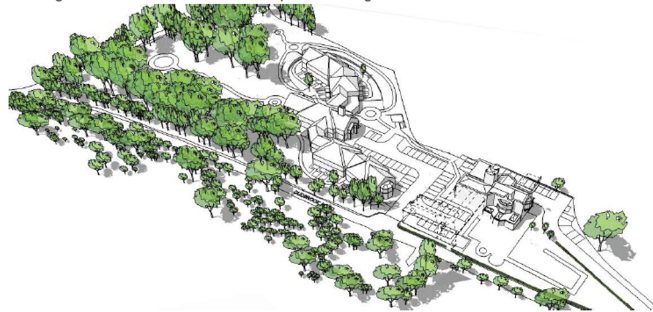

Proposed 3D View of proposed care home with the new renovated nursery

The new development will be built first on the west of the site to avoid disrupting the services and care of the residents in the existing care home. Once completed residents will be relocated into the new care home before the north and south extensions to the existing care home are demolished. This will commence the renovation of the building's alternate use as a nursery.

- EXISTING CARE HOME
- PROPOSED DEVELOPMENT
- DEMOLITION